



**Pressure Relief Valve
Pressure Reducing Valve with Check Valve**



Pressure relief valve

Protection against exceeding the max. operating pressure of the fixture (safety valve) or limiting of working pressures.

Type	Poppet valve, directly controlled
Type of mounting	Installation in line
Port size	G 1/2
Weight approx.	0.3 kg

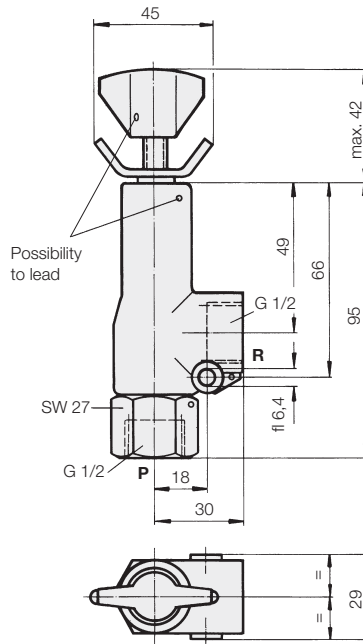

Øp-Q- curves

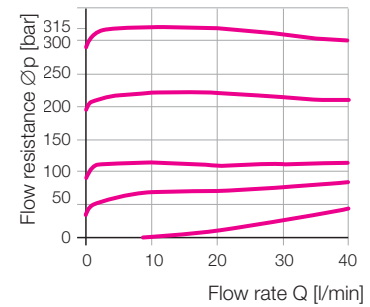

Oil viscosity during measurement 50 mm²/s

Hydraulic characteristics

Range of adjustment	[bar]	0...500
Oil temperature	[°C]	-25...+80
Max. flow rate	[l/min]	40
Max. operating pressure		
Port P	[bar]	500
Port R	[bar]	20
Part-no.		2952-521
Max. operating pressure		
Ports P and R	[bar]	500
Part-no.		2952-525



Pressure reducing valve with check valve

Type	Spool valve
Type of mounting	In-line pipe or bulk head mounting
Port size	G 1/4
Weight approx.	1.7 kg

ND 5

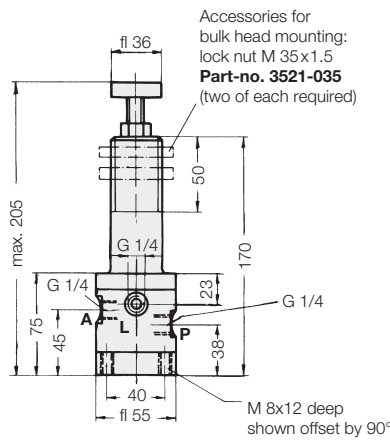

Øp-Q-curve for kinematic viscosity of 36x10⁻⁶ m²/s (HLP 46 at 50 °C)

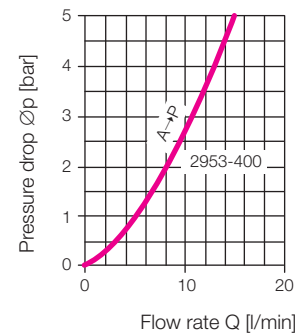

Hydraulic characteristics

Range of adjustment	[bar]	10...150
Max. operating pressure	[bar]	200
Leakage	[cm ³ /s]	approx. 0.5 at set pressure 100 bar
Part-no.		2953-400

Important note!

The leakage oil line "L" to the reservoir must be without pressure.