

ROEMHELD
HILMA ■ STARK

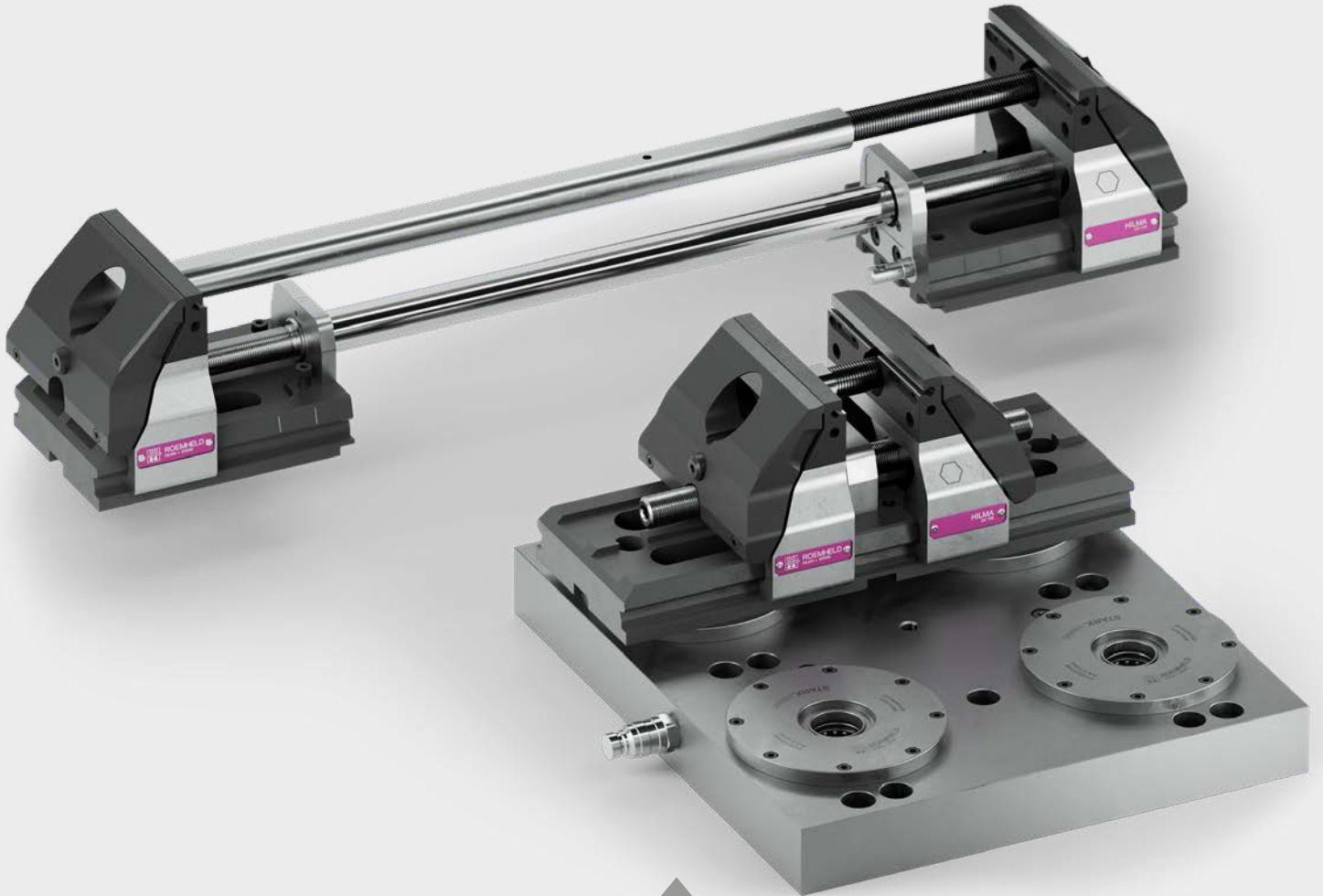

HILMA.UC

5-axis clamping system

Concentric, modular, precise

Jaw width 125 mm



ROEMHELD
HILMA ■ STARK



STARK INNOVATIVE PROFICIENT INDIVIDUAL SAFE

The high-tech company STARK Spannsysteme was established in 1977 in Rankweil, Austria. It manufactures zero point clamping systems and vises of the highest quality and precision for international clients in the automotive, aviation and medical industries, for example.

STARK Spannsysteme products are a byword for minimal set-up times, faster production and high flexibility.

HILMA vises can be complemented and combined perfectly with STARK zero point clamping systems.

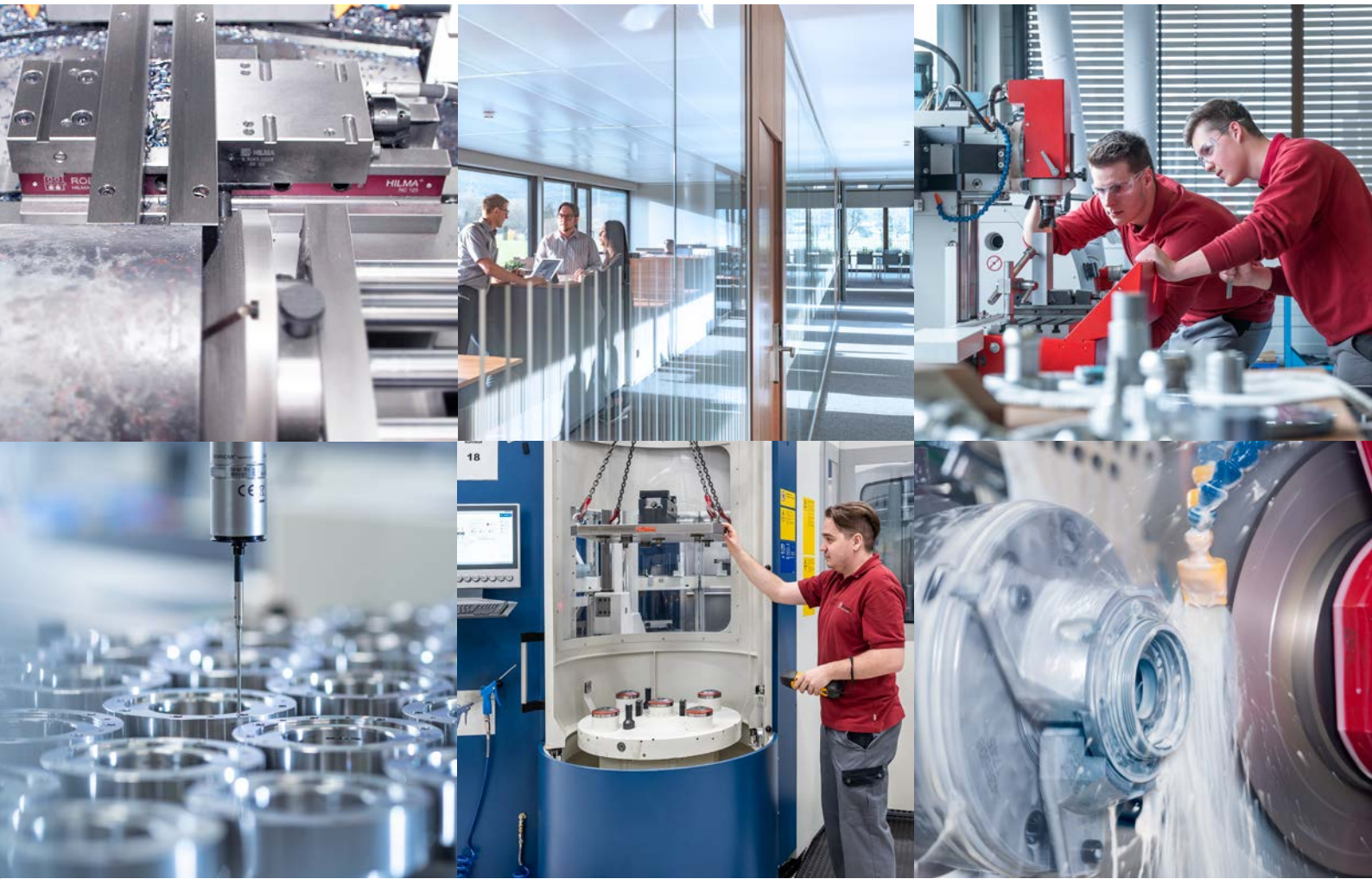

AUTOMOTIVE



AVIATION



MACHINE AND TOOL
CONSTRUCTION



MEDICINE

FOCUS ON INDUSTRIES & MARKETS.

Every customer has specific requirements. Our established and extensive industry expertise allows us to offer you the best solutions, services and products for sustainable and efficient use in your market.

HILMA.UC 125

UNIVERSAL
STABLE
COMPACT
PRECISE

modular system enables versatile clamping options
no deflection thanks to closed force flow
reduced design ensures optimum accessibility
true to position due to pull-down mechanism

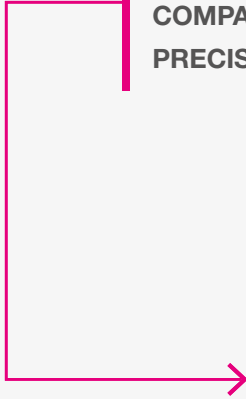

HILMA.MCP

HILMA.UC



HILMA.SCS



HILMA.KNC



HILMA.SCT



HILMA.NC



HILMA.TS Vector



HILMA.DS



HILMA.TS TriStar



HILMA.ASE



HILMA.ASH



TABLE OF CONTENTS **HILMA.UC**

HILMA.UC 5-axis clamping system	6	Fastening variants	20
Benefits	8	Direct mounting	20
Operating principle	10	Fastening via adapter plate	21
HILMA.UC 125	11	Adapter plates	22
Flexible clamping widths	12	Retractable nipple for NPS	23
Extension set 400	13	Fast closing plate	24
Extension set 600	13	Raiser	25
Extensive range of clamping jaws	14	Fastening accessories	26
Pull-down clamping jaws		Order number list	27
Clamping jaws 60 mm, smooth			
Clamping jaws 25 mm, smooth			
Clamping jaws with GripPins 60 mm	16		
Clamping jaws with GripPins 125 mm			
GripPins			
Prism jaws	17		
Support bars 3.5 mm			
Support bars 5.5 mm	18		
Soft clamping jaw			
Clamping jaw with round clamping bolt			
Round clamping bolt	19		

HILMA.UC

5-axis clamping system

Pull-down mechanism

The clamping force is applied to the workpiece via the outer edges of the clamping claws above the workpiece stop without touching it directly

Extensive range of clamping jaws for different clamping tasks

Support bars for different clamping depths

The centre bearing holds the workpiece precisely in the centre with repetitive accuracy

Wide guideways for the clamping elements without air gap and without mechanical load

Locating pin for positioning

Retractable nipple for STARK zero point clamping system

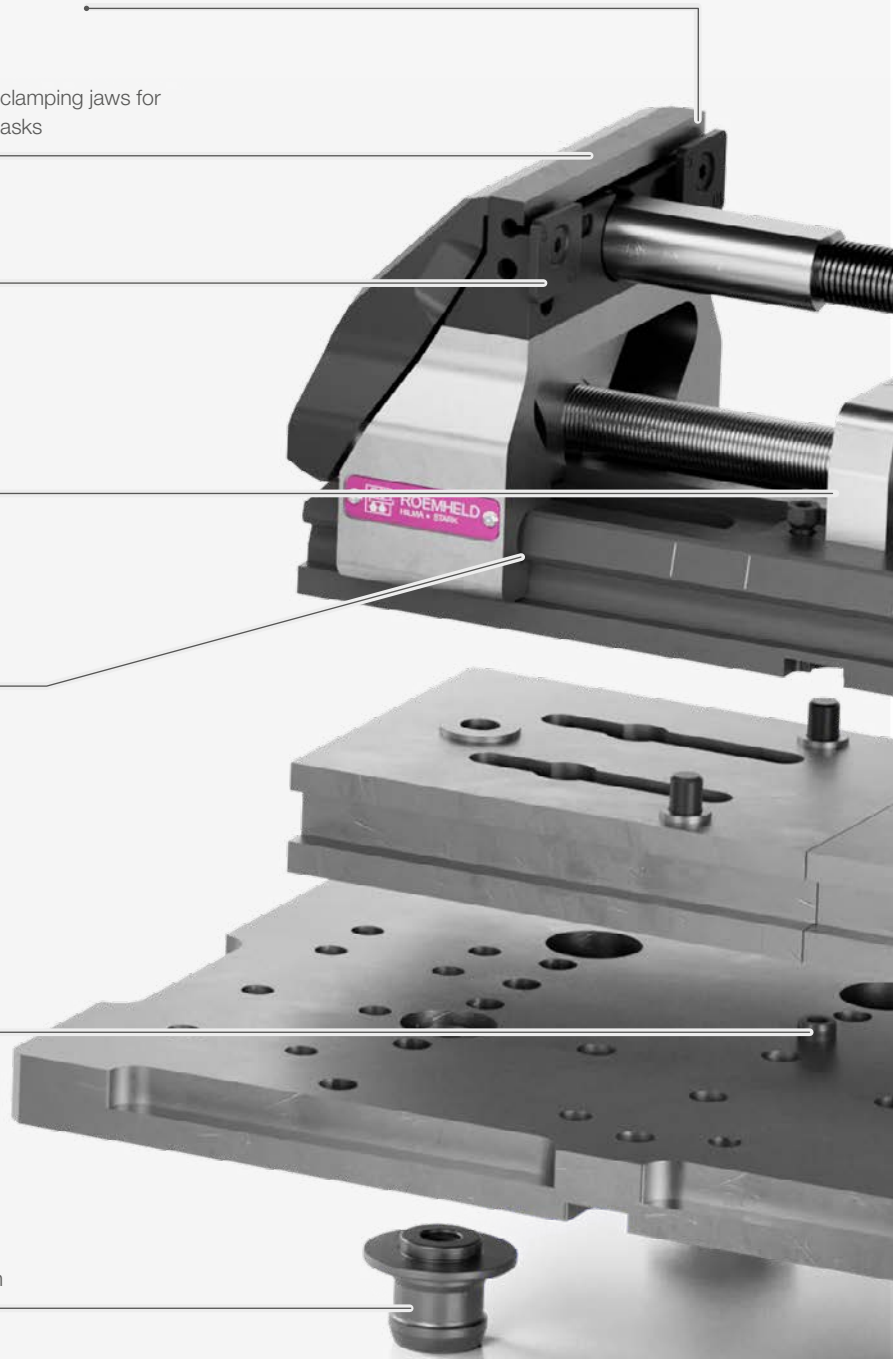



Tension spindles and clamping nuts for jaw openings 0-200 mm included in the standard scope of delivery

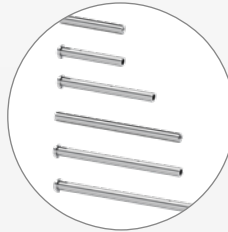

Accessories for extended jaw openings up to 600 mm

The mechanical actuation takes place via the self-cleaning tension spindle with fine thread

Icon for operating side

The self-cleaning adjustment spindle is not mechanically loaded - it is only used for positioning

Raiser for optimised accessibility

Adapter plates for more flexibility

Zero point clamping system bore holes for retractable nipple as standard version in the base, in raiser and in adapter plates

MAXIMUM FLEXIBILITY

The **HILMA.UC** machine vise

The clamping system **HILMA.UC** is suitable for numerous clamping tasks and is used for machining dimensionally stable workpieces in single or multiple clamping systems.

Small workpieces as well as large plates can be clamped and machined without large interference contours. Even when production requirements change, there is no need to invest in new clamping devices.

- For 3-, 4- or 5-axis machining centres
- Milling machines and milling/turning centres

The concentric clamping device **HILMA.UC** can be easily adapted to different

workpiece geometries and is suitable for series production as well as for individual production.

Mechanical operation

- via spindle
- Spindle applies a pulling force of up to 52 kN (120 Nm)

Concentric clamping

- the centre bearing holds the workpiece precisely in the centre with repetitive accuracy

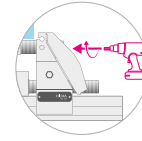

Operation
mechanical

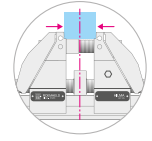

Clamping principle
concentric

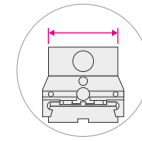

Jaw width
125 mm

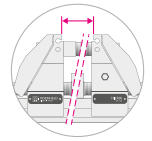

Jaw opening
0 - 600 mm



High stability

- Closed force flow - no bending force effect in the base
- + No deflection

- Separation of adjusting and tension spindle
- + Optimum force flow

- Pull-down clamping jaws
- + Active workpiece pull-down

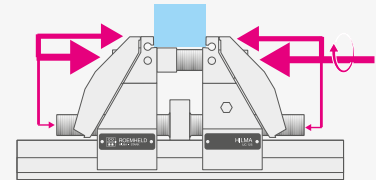

Optimum accessibility

- Compact design
- + good accessibility - optimum tool length can be used due to smallest interference contour

- Raiser as accessory
- + improved accessibility for special clamping tasks

▶ more on page 15

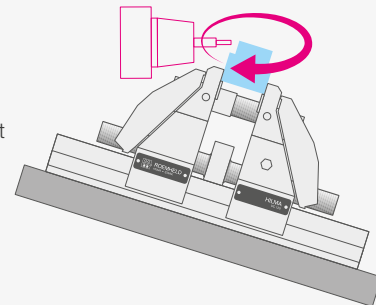



Concentric clamping system

- Centre clamp, optimal for 5-axis applications
- + precise with repetitive accuracy
- + split mounting option

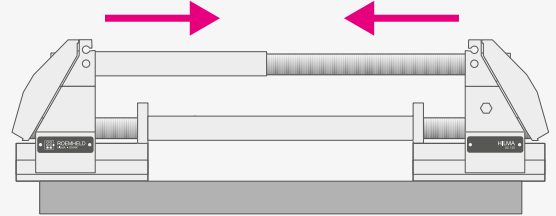

Flexible jaw opening & range of clamping jaws

- Standard jaw opening from 0 - 200mm, extension sets for extended jaw opening up to 600mm
- Conclusive range of clamping jaws for workpieces in all shapes and surfaces from round to square, small to large and smooth or uneven
- + can be adapted to differently-sized workpiece geometries in just a few steps
- + variable clamping depths
- + optimised accessibility

- ▶ more about the extension sets on page 13
- ▶ more about the extension sets on page 14

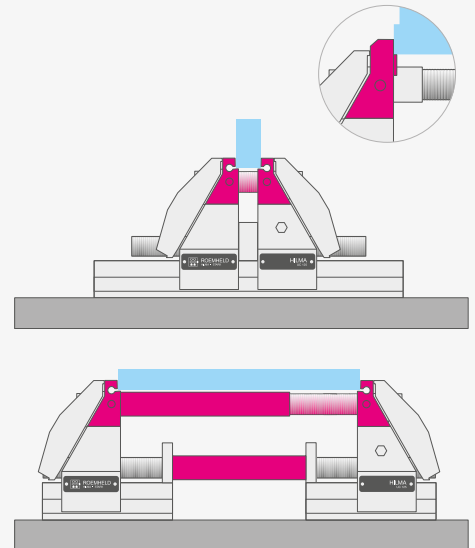

Individual fastening

- fastening with sliding block on T-slot table
- fastening via clamping claws
- fastening from above through the base by means of screws
- quick change by means of STARK retractable nipple directly or via adapter plate in the STARK zero point clamping system
- thread adapters for alternative zero point clamping system manufacturers
- standard fast closing plates available

- ▶ more about fastening on page 20

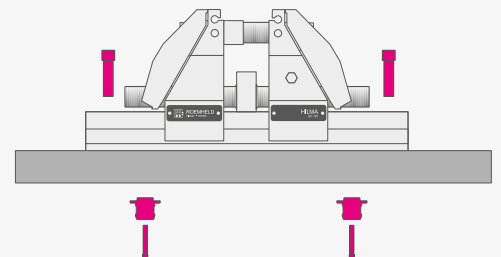

CONCENTRIC CLAMPING DEVICE WITH PULL-DOWN MECHANISM

Operating principle **HILMA.UC**

INFO

Clamping principle - closed force flow

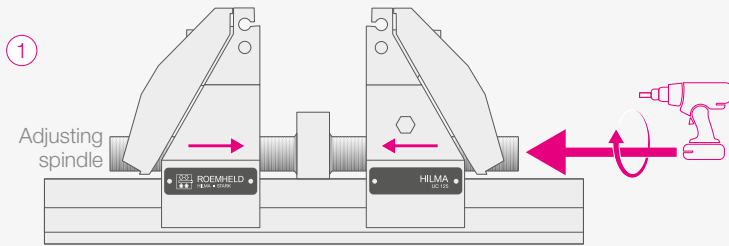

- ① The clamping range is preset until both clamping jaws are in contact with the workpiece without building up clamping force.

By turning the adjustment spindle clockwise, both adjustment elements move to the centre.

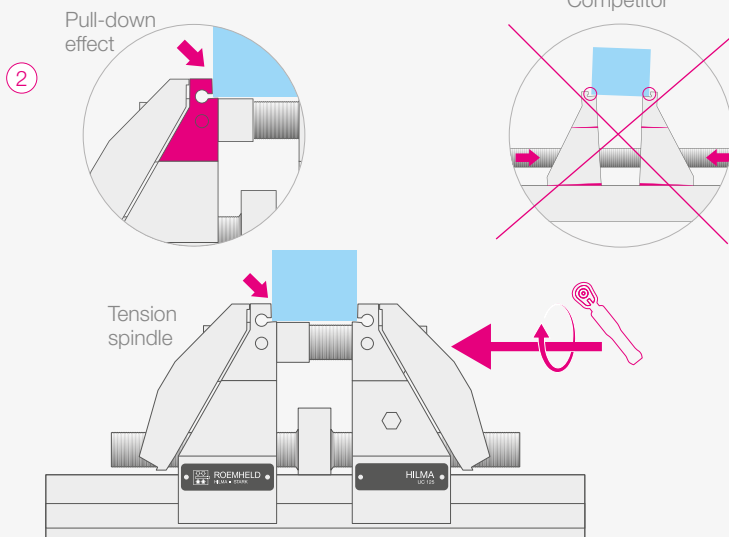

- ② The tension spindle is mounted hand-tight before the clamping force is applied by turning it clockwise using a torque wrench.

The force on the clamping jaws above the workpiece stop is introduced into the workpiece via the outer edges of the clamping claws.

The clamping force develops proportionally to the torque.

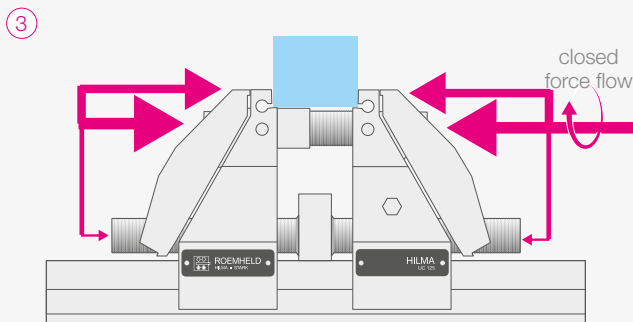

- ③ Most of the pulling force is applied directly to the workpiece. The adjustment spindles serve as counter bearings.

In the process, the adjustment elements are clamped to the base plate and the system is completely mechanically locked.

Due to the closed power flow from tension spindle to adjustment spindle, the base remains almost without bending force being applied and tilting of the adjustment elements is avoided.

HILMA.UC 125

The **HILMA.UC 125** is a universal 5-axis concentric clamp with mechanical actuation and a jaw width of 125 mm.

The clamping nuts and tension spindles included in the standard scope of delivery allow a maximum clamping range of 200 mm, which can be extended to 600 mm with extension sets. The concentric clamp is supplied with pull-down clamping jaws for clamping pre-machined and smooth surfaces. Retractable nipple bore holes for zero point clamping systems are prepared in the base for fastening.

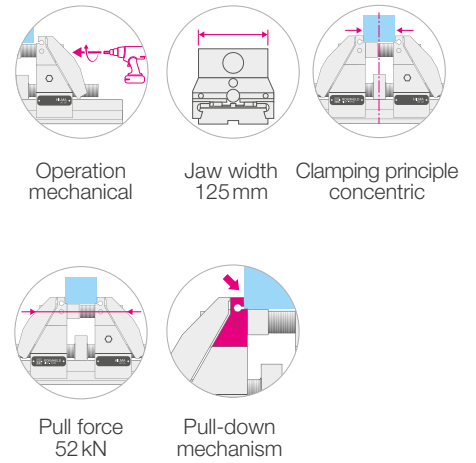
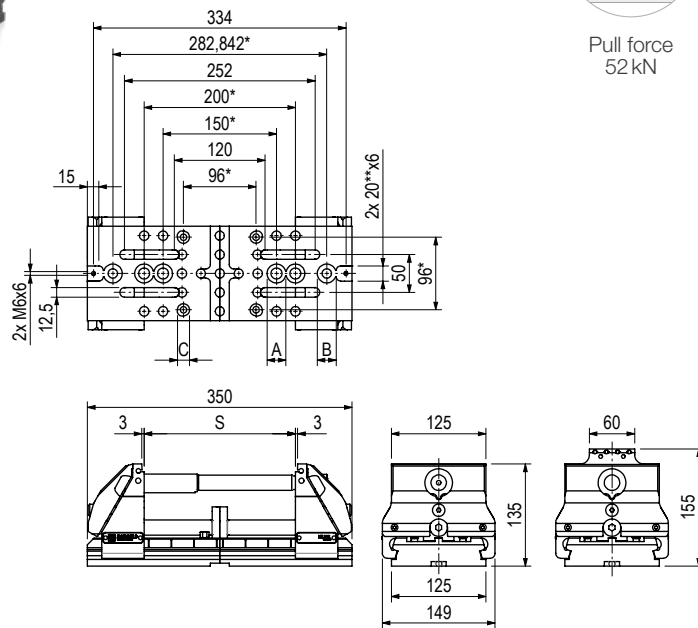

Figure: 970230101
Standard scope of delivery:
Machine vise incl. pull-down clamping jaws,
clamping nut short and long,
tension spindle short and long



Z_970230101_03

* Tolerance ± 0.02, ** tolerance + 0.02
All dimensions in [mm]

Series		HILMA.UC 125
Operation		mechanical
Base length ¹⁾	[mm]	350
Pull force	[kN]	52
Clamping principle		concentric
Clamping range S ²⁾	[mm]	0 - 200 (max. 600)
Retractable nipple bore hole A	[mm]	4x Ø 25 H7 x 6; 4x M16x1.5 x 18
Retractable nipple bore hole gauge	[mm]	200
Bore hole for fastening from above B	[pc]	2x Ø 25 H7 x 6; 2x flat sink for M12 from above
96 x 96 retractable nipple bore hole gauge C	[mm]	4x Ø 16 ± 0.01 x 6; 4x M10 x 10
Weight with pull-down clamping jaws	[kg]	20
Order no.		970230101

¹⁾ Base part length without extension with a clamping range of max. 200mm
²⁾ Extension sets for clamping ranges up to 400 mm and up to 600 mm available as accessories ▶ more on page 12 & 13
Subject to technical changes, all data without guarantee



EXTENSION SETS FOR MAXIMUM JAW OPENINGS

Flexible clamping widths

The concentric clamping system can be divided in the middle and extended. The clamping range can be extended up to 600 mm by using different tension spindle/clamping nut combinations.

A closed force flow is created between the tension spindle, adjustment element and clamping jaw, thus allowing the modular design. The base plate remains without a bending force being applied.

The extended clamping system can be mounted directly on the machine table, raisers or adapter plates.

Standard jaw opening 0 - 200mm

Four elements for adjusting the clamping range are included in the standard scope of delivery.

- Tension spindle, short
- Tension spindle, long
- Clamping device, short
- Clamping nut, long



The following clamping ranges can be combined

0 - 50 mm

Short tension spindle and short clamping nut



48 - 104 mm

Short tension spindle and long clamping nut



100 - 200 mm

Long tension spindle and long clamping nut



Extension set 400 for extended clamping range

The clamping range can be extended to a maximum of 400mm with the extension set 400. The minimum clamping range is increased to min. 196mm by the extension on the adjustment spindle.

The scope of delivery includes two differently-sized clamping nuts and an extension for the adjustment spindle.



Order no.	Extension set 400
	Clamping nut 300
970235002	Clamping nut 400
	Extension for adjustment spindle 200

The following clamping ranges can be realised

196-300 mm

Long tension spindle
(standard scope of delivery)
Clamping nut 300mm
Adjustment spindle 200mm



296-400 mm

Long tension spindle
(standard scope of delivery)
Clamping nut 400mm
Adjustment spindle 200mm



Extension set 600 for maximum clamping range

The clamping range can be extended to a maximum of 600mm with the extension set 600. The minimum clamping range is increased to min. 396mm by the extension on the adjustment spindle.

The scope of delivery includes two differently-sized clamping nuts and an extension for the adjustment spindle.



Order no.	Extension set 600
	Clamping nut 500
970235003	Clamping nut 600
	Extension for adjustment spindle 400

The following clamping ranges can be realised

396-500 mm

Long tension spindle (standard
scope of delivery)
Clamping nut 500mm
Adjustment spindle 400mm



496-600 mm

Long tension spindle (standard
scope of delivery)
Clamping nut 600mm
Adjustment spindle 400mm



THE OPTIMUM JAW FOR EVERY WORKPIECE

Extensive range of clamping jaws

High clamping quality



High clamping safety

The jaws used have a major influence on the machining result. The range of clamping jaws enables reliable blank and finished part clamping in all shapes from round to square and from small to large.

For smooth clamping jaws and clamping jaws with GripPin, support bars are required as workpiece stops.

▶ more about support bars on page 18



Finished parts

Clamping jaw 125mm & 60mm, smooth
Page 16



Blanks

Clamping jaw with GripPins 125mm & 60mm
Page 16 & 17



Three-point clamping

Clamping jaw with round clamping bolts
Page 19



Finished part, smooth surface

Pull-down clamping jaws, page 16

Figure: 970230101
HILMA.UC with standard pull-down clamping jaws



Round parts, large

Clamping jaw with round clamping bolts
Page 19



Cylindrical workpieces

Prism jaw
Page 17



Blank with special shape

Soft clamping jaw, with specific clamping contour
Page 19

Pull-down clamping jaws 125 mm, hardened

Suitable for clamping pre-machined or smooth surfaces (second side). The bending element of the jaw clamps the workpiece with pull-down and presses it onto the support surface with repetitive accuracy.

Support bars are optional for the clamping jaw. ▶ Page 18

Pull-down clamping jaws are included in the HILMA.UC standard scope of delivery.

Order no.	Clamping range	Supply
970236001	6 - 206 mm*	2 pcs. clamping jaws 4 pcs. fixing screws

*Standard clamping range without extension set

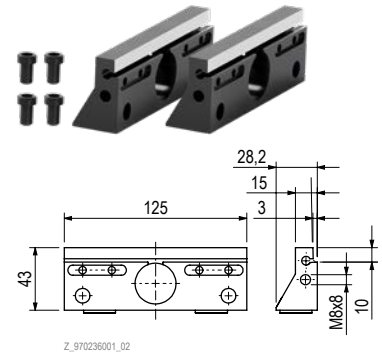

Z_970236001_02

All dimensions in [mm]
Fastening material included in scope of delivery

Clamping jaws 60 mm, smooth, hardened

For clamping pre-machined or smooth surfaces (second side). The narrow version of the clamping jaw has a clamping width of 60 mm and serves to optimise accessibility for narrow workpieces.

The maximum clamping depth is 28 mm. Support bars are required for the clamping jaw. ▶ Page 18

Order no.	Clamping range	Supply
970236007	0 - 190 mm*	2 pcs. clamping jaws 4 pcs. fixing screws

*Standard clamping range without extension set

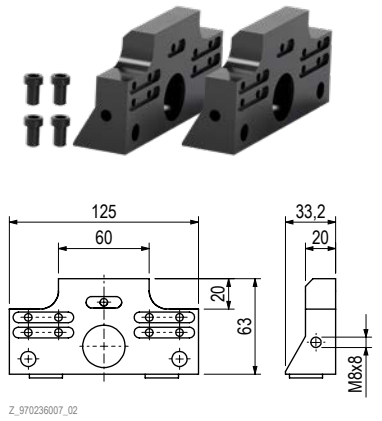

Z_970236007_02

All dimensions in [mm]
Fastening material included in scope of delivery

Clamping jaws 125 mm, smooth, hardened

For clamping pre-machined or smooth surfaces (second side). The clamping jaw has a clamping width of 125 mm, the maximum clamping depth is 28 mm. Support bars are required for the clamping jaw. ▶ Page 18

Order no.	Clamping range	Supply
970236006	0 - 190 mm*	2 pcs. clamping jaws 4 pcs. fixing screws

*Standard clamping range without extension set

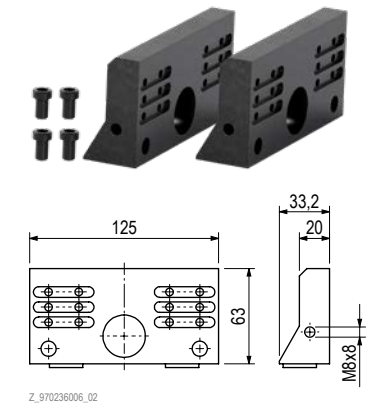

Z_970236006_02

All dimensions in [mm]
Fastening material included in scope of delivery

Clamping jaws with GripPins 60 mm

For secure clamping of uneven surfaces such as saw cuts, blanks and cast parts. The narrow version of the clamping jaw with GripPins has a clamping width of 60 mm and serves to optimise accessibility for narrow workpieces.

Attention: Marks of the pins on the workpiece. The maximum clamping depth is 28 mm. Support bars are required for the clamping jaw. ▶ Page 18

Order no.	Clamping range	Supply
970236003	0 - 190 mm*	2 pcs. clamping jaws incl. 2 x 6 pcs. GripPins 4 pcs. fixing screws

*Standard clamping range without extension set

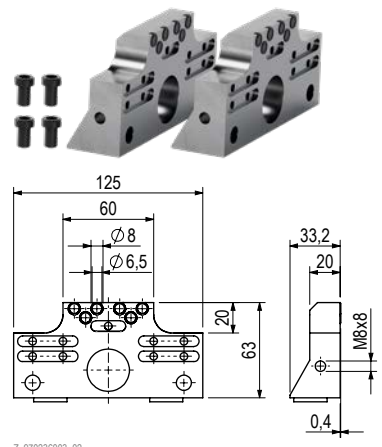

Z_970236003_02

All dimensions in [mm]
Fastening material included in scope of delivery

Clamping jaws with GripPins 125 mm

For secure clamping of uneven surfaces such as saw cuts, blanks and cast parts. The clamping jaw has a clamping width of 125mm, the maximum clamping depth is 28mm. Attention: Marks of the pins on the workpiece.

Support bars are required for the clamping jaw. ▶ Page 18

Order no.	Clamping range	Supply
970236002	0 - 200mm*	2 pcs. clamping jaws incl. 2 x 9 pcs. GripPins 4 pcs. fixing screws

*Standard clamping range without extension set

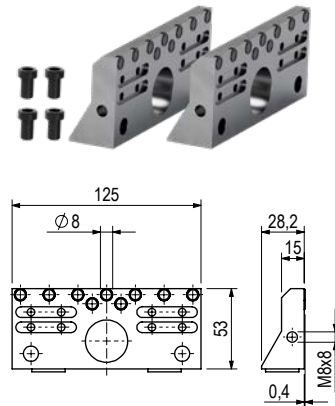

Z_970236002_02

All dimensions in [mm]
Fastening material included in scope of delivery

GripPins, hardened

If the pins are worn, they can be replaced in the existing clamping jaw.
Attention: Marks of the pins on the workpiece.

Order no.	Supply
970235004	10 pcs. spare pins D7

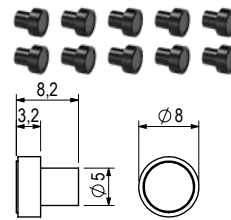

Z_970235004_02

All dimensions in [mm]
Fastening material included in scope of delivery

INFO

Change GripPins

With the help of a punch, worn pins can be knocked out of the jaw and new ones inserted.



9 GripPins at 125mm

Prism jaws, hardened

For clamping cylindrical workpieces with a diameter of 8-40mm.
Workpieces can be clamped horizontally or vertically. With vertical clamping it is possible to place two workpieces in the outer prisms at the same time.
Support bars are optional for the clamping jaw. ▶ Page 18

Order no.	Clamping range	Supply
970236004	8 - 40mm*	2 pcs. Prism jaws 4 pcs. fixing screws

*Standard clamping range without extension set

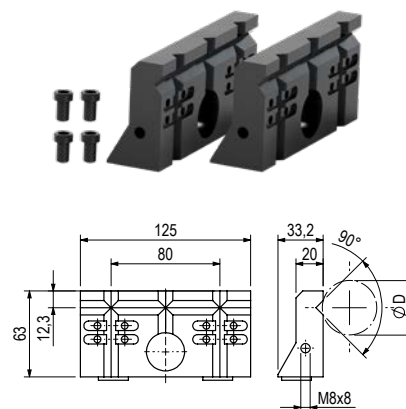

Z_970236004_02

All dimensions in [mm]
Fastening material included in scope of delivery

Set of support bars 3.5 mm, hardened

Support bars with 3.5 mm thickness. A support surface for the workpiece is created by attaching the support bars. The clamping depth varies depending on the positioning of the support bar and the selection of the fastening step. The support bars are suitable for all clamping jaws except soft clamping jaw (970236008) and clamping jaw with round clamping bolt (970236005).

Order no.	Clamping range	Supply
970235005	min. 7 mm	4× support bars 3.5 mm for 3 mm/8 mm height of supports 4× support bars 3.5 mm for 5 mm/10 mm height of supports 4 pcs. fixing screws

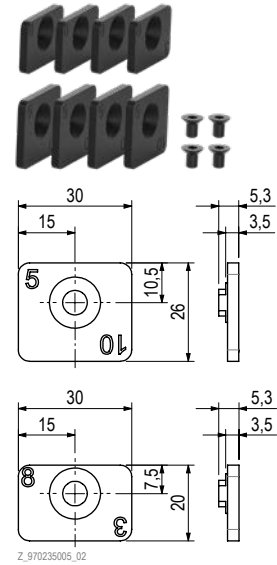

All dimensions in [mm]
Fastening material included in scope of delivery

Set of support bars 5.5 mm, hardened

Support bars with 5.5 mm thickness. A support surface for the workpiece is created by attaching the support bars. The clamping depth varies depending on the positioning of the support bar and the selection of the fastening step. The support bars are suitable for all clamping jaws except soft clamping jaw (970236008) and clamping jaw with round clamping bolt (970236005).

Order no.	Clamping range	Supply
970235017	min. 11 mm	4× support bars 5.5 mm for 3 mm/8 mm height of supports 4× support bars 5.5 mm for 5 mm/10 mm height of supports 4 pcs. fixing screws

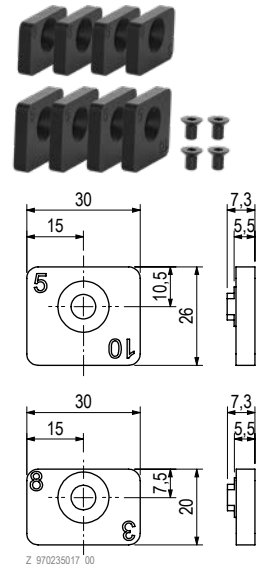

All dimensions in [mm]
Fastening material included in scope of delivery

INFO

Support bar application

The support bar creates a workpiece stop and at the same time determines the clamping depth for the workpiece. According to the desired clamping depth, the support bar can be aligned and inserted into the matching slot of the clamping jaw.

Support bar	Clamping depth 1st step	Clamping depth 2nd step	Clamping depth 3rd step
3/8 mm	3 mm	13 mm	23 mm
	8 mm	18 mm	28 mm
5/10 mm	5 mm	15 mm	25 mm
	0 mm	10 mm	20 mm

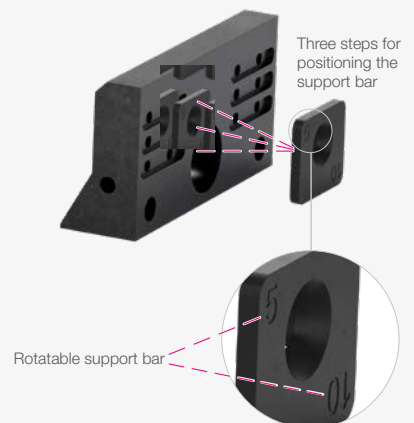

Soft clamping jaws

Soft jaw for customer insertion of workpiece-specific clamping contours.

Order no.	Clamping range	Supply
970236008	0 - 190mm*	2 pcs. clamping jaws 4 pcs. fixing screws

*Standard clamping range without extension set

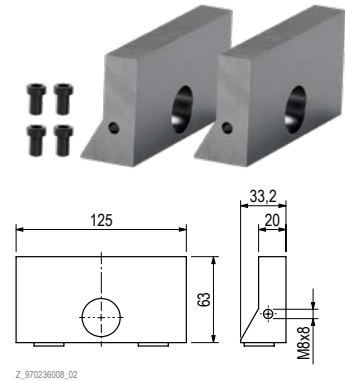

All dimensions in [mm]
Fastening material included in scope of delivery

Clamping jaws with round clamping bolts

For vertical clamping of cylindrical workpieces with a diameter of 30 bis 200 mm. The diameter can be flexibly adjusted by repositioning the inserts. Three- and four-point clamping can be realised. Attention: Clamping marks on the workpiece possible.

Order no.	Clamping range	Supply
970236005	30 - 200mm*	2 pcs. clamping jaws incl. 4 pcs. round clamping bolt 4 pcs. fixing screws

*Standard clamping range without extension set

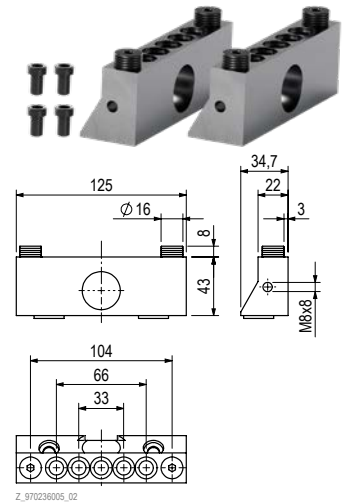

Round clamping bolts

If the round clamping bolts are worn, they can be replaced in the existing clamping jaw. Attention: Marks on the workpiece.

Order no.	Supply
970235016	2 pcs. round clamping bolts

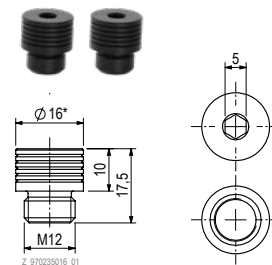

All dimensions in [mm]
Fastening material included in scope of delivery

INFO

Round clamping bolts application

The replaceable round clamping bolts make these clamping jaws universally usable. They can be used for clamping large round plates as well as small cylindrical components.

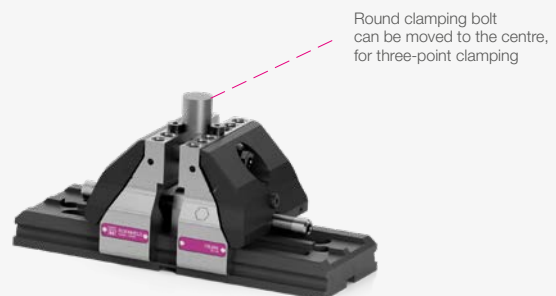

OPTIONS FOR FASTENING ON THE MACHINE TABLE

Fastening options

Stable Fastening on the machine table is of great importance to ensure precise machining. Fastening options can be selected depending on the type of processing and the individual requirements.

Direct mounting
Adapter plate



Sliding blocks and screws
Clamping claws
Zero-point mounting system

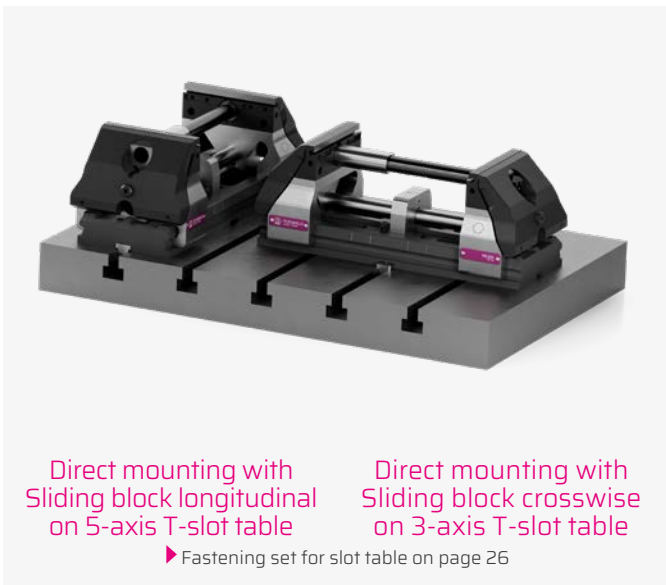

Direct mounting with Sliding block longitudinal on 5-axis T-slot table
▶ Fastening set for slot table on page 26

Direct mounting with Sliding block crosswise on 3-axis T-slot table



Direct mounting with retractable nipples in the STARK zero point clamping system
▶ Fastening set for retractable nipple on page 23
▶ Quick-action coupling on page 24



Direct mounting with screws from above on hole pattern with raiser on right image
▶ Raiser on page 25

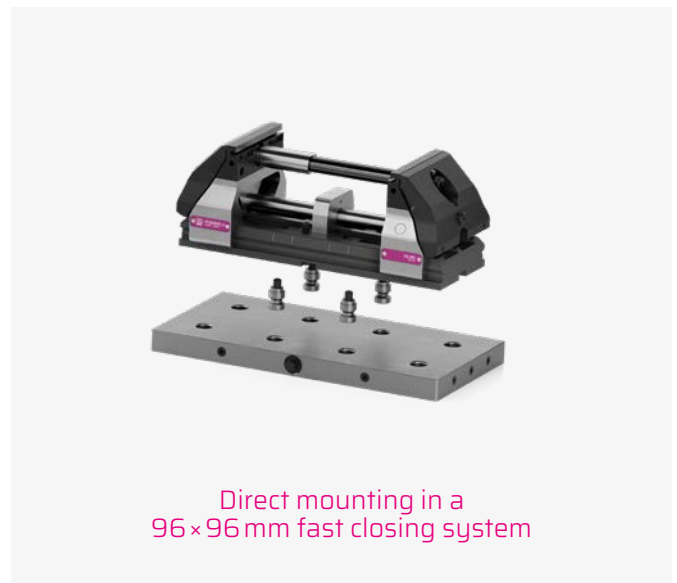

Direct mounting in a 96×96 mm fast closing system



Fastening on adapter plate

- ▶ Adapter plates on page 22
- ▶ Fastening set on page 26



**Fastening via adapter plate
in zero point clamping system**

- ▶ Fastening set for retractable nipple on page 23
- ▶ Fast closing plate on page 24

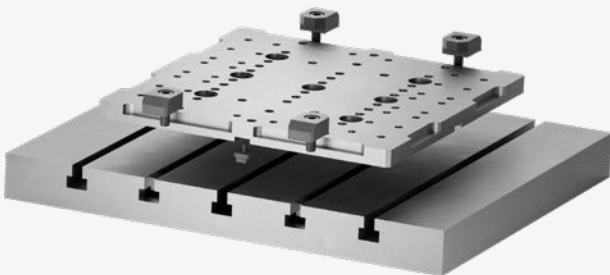

**Fastening via adapter plate
with clamping claws**

- ▶ Fastening set for clamping claws on page 26

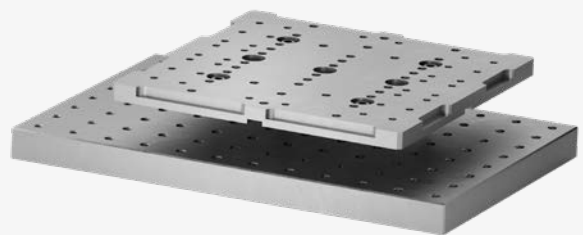

**Fastening via adapter plate
on hole pattern**

- ▶ Fastening set on page 26

Adapter plates

The adapter plates allow the flexibility of the system to be optimally utilised.

- + Simplified assembly
- + Defined interface below
- + Flexible interface above

The locating pins included in the fastening set allow the HILMA.UC to be positioned precisely on the adapter plate, both in the standard version and in the extended version.

Fastening set ▶ Page 23

Order no.	Description	Weight
970235008	1 × adapter plate 150 × 400 mm Bore hole for retractable nipple Bore holes for locating pins and fixing screws	9 kg
970235009	2 × adapter plate 400 × 400 mm Bore hole for retractable nipple Bore holes for locating pins and fixing screws	25 kg
970235010	3 × adapter plate 600 × 400 mm Bore hole for retractable nipple Bore holes for locating pins and fixing screws	37.6 kg

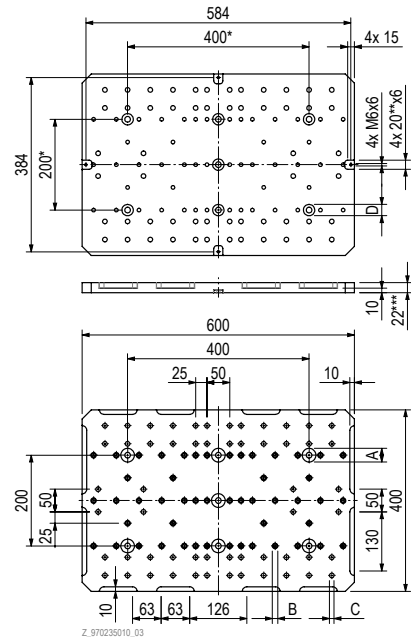
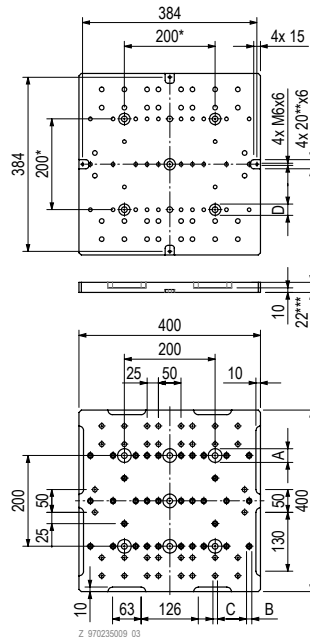
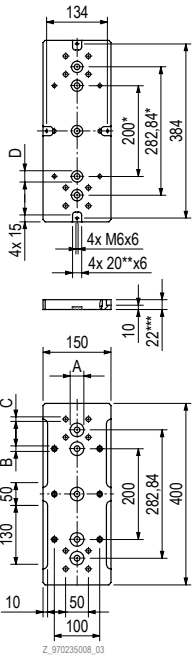

Alle Abmessungen in [mm]
Befestigungsmaterial in Lieferumfang enthalten

INFO

Fastening examples on adapter plate



400 × 400 mm
Two HILMA.UC placed next to each other on the outside

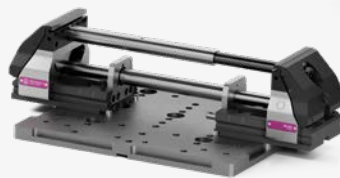

400 × 400 mm
One HILMA.UC with extension 400 mm placed centrally



400 × 400 mm
Two HILMA.UC with extension 400 mm placed next to each other on the outside

Retractable nipple for NPS

Thanks to the integrated retractable nipple bore holes in the visebase, HILMA machine vises can be perfectly supplemented and combined with STARK zero-point clamping systems. A zero point clamping system consists of a quick-release fastener into which

retractable nipples are clamped. In order to compensate for manufacturing tolerances and the necessary "mobility for thermal expansion" on a pallet (temperature change), three different types of retractable nipples are combined.

Retractable nipple set for SVP STARK.classic.2

Set for direct mounting of the HILMA.UC vise.



Order no.	Supply
970235014	Retractable nipple with zero point STARK.classic.2 NP Screws for mounting from below and above Threaded insert M10
	Retractable nipple with compensation STARK.classic.2 AG Screws for mounting from below and above Threaded insert M10

Retractable nipple set for SVP STARK.basic.M



Order no.	Supply
970235015	Retractable nipple with zero point STARK.basic.M NP Screws for mounting from below and above Threaded insert M10
	Retractable nipple with compensation STARK.basic.M AG Screws for mounting from below and above Threaded insert M10

Retractable nipple for SVP STARK.classic.2



Individual retractable nipples for individual combination depending on the application. Threaded inserts are required for the retractable nipples. ▶ Page 26

Order no.	Retractable nipple
S804-470	with zero point STARK.classic.2 NP
S804-471	with compensation STARK.classic.2 AG
S804-472	without centring STARK.classic.2 OZ

Retractable nipple for SVP STARK.basic.M



Individual retractable nipples for individual combination depending on the application. Threaded inserts are required for the retractable nipples. ▶ Page 26

Order no.	Retractable nipple
S8000-300	with zero point STARK.basic.M NP
S8000-301	with compensation STARK.basic.M AG
S8000-302	without centring STARK.basic.M OZ

INFO

Compensation principle

The combination of retractable nipples depends on the number.

- ⊕ Retractable nipple with zero point (NP)
- ⊖ Retractable nipple with compensation (AG)
- Retractable nipple without centring (OZ)

Assignment example

2x adapter plate on 4x SVP

NP - OZ

OZ - AG

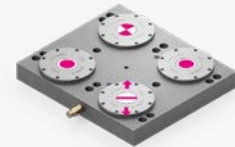

Assignment example

3x adapter plate on 6x SVP

NP - OZ

OZ - OZ - AG

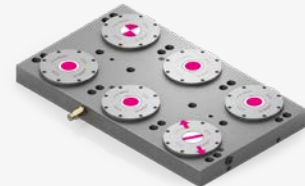



Fast closing plates for NPS

STARK standard fast closing plates (SVP) are a cost-effective entry-level solution for high-quality zero point clamping systems (NPS) and provide a secure and versatile connection between the machine vise and machine table.

- SVP made of steel ground on both sides

with mounting holes for different slot spacings

- NPS is clamped mechanically with spring force and released hydraulically/pneumatically

- Application area on 3-, 4- and 5-axis machines for all common machining operations such as milling, grinding, eroding



Standard fast closing plate STARK.classic

- Hydraulic releasing system
- up to 120kN active retractable force

Order no.	Quick-locking plate	Size	Gauge for bore holes
S804-726	SVP with 4 STARK.classic.2 (S804-452)	4x 396x346x46 mm	200x200 mm
S804-727	SVP with 6 STARK.classic.2 (S804-452)	6x 596x346x46 mm	200x200 mm

Standard fast closing plate STARK.basic

- Pneumatic releasing system
- up to 54 kN retention force



Order no.	Quick-locking plate	Size	Gauge for bore holes
S805-307	SVP with 4 STARK.basic.M (S805-202)	4x 396x346x46 mm	200x200 mm
S805-308	SVP with 6 STARK.basic.M (S805-202)	6x 596x346x46 mm	200x200 mm

Raiser

Raiser for optimised accessibility.

- + Increased degree of freedom / improved accessibility for special clamping tasks

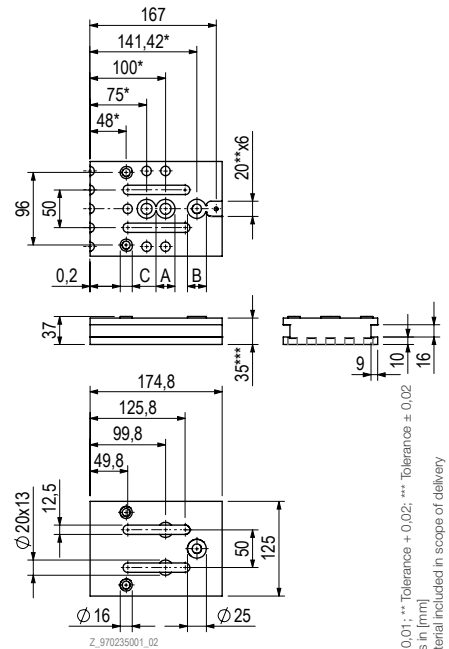

* Tolerance ± 0.01; ** Tolerance + 0.02; *** Tolerance = 0.02
All dimensions in [mm]
Fastening material included in scope of delivery

Order no.	Scope of delivery
970235001	2 pcs. raisers 4 pcs. fixing screws M10 x 45 mm

INFO

Example Fastening with raiser

The raiser is placed between the vise and the adapter plate.





Fastening accessories

Fastening set for slot table

For positioning and mounting the clamping system on a T-slot table, hole pattern table or adapter plate.



Order no.	Scope of delivery
970235007	2 pcs. fitting sliding block 14/18 2 pcs. M6 × 16 4 pcs. T-nut 18 mm 4 pcs. T-nut 14 mm 4 × M12 × 40 mm incl. washers 4 × locating pins 12 × 20

Clamping claw set

For mounting adapter plates or clamping systems.

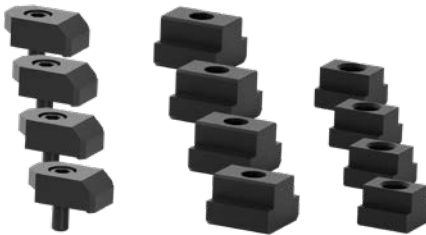

Order no.	Scope of delivery
970235006	4 pcs. clamping claws 4 pcs. M12 × 30 mm 4 pcs. T-nut 18 mm 4 pcs. T-nut 14 mm

Inserts for thread

For fastening with STARK retractable nipples, the standard M16 tapped holes can be reduced to M8/M10/M12 by means of threaded inserts.

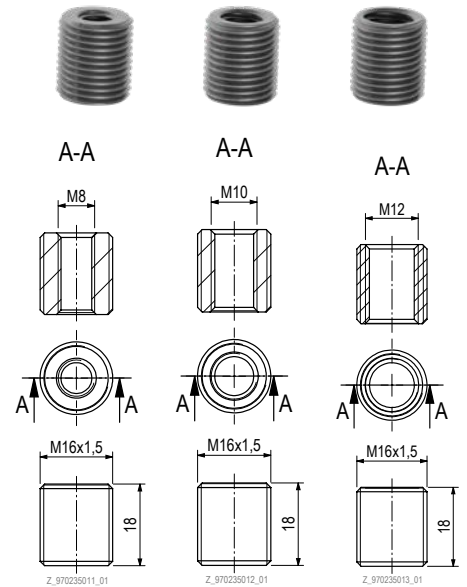

Order no.	Retractable nipple
970235011	Inserts for M8 thread
970235012	Inserts for M10 thread
970235013	Inserts for M12 thread

- Further accessories such as Allen key, torque wrench and battery attachment on request.

Order number directory

97235008	22
97235009	22
97235010	22
970230101	11
970235001	25
970235002	13
970235003	13
970235004	17
970235005	18
970235006	26
970235007	26
970235011	26

970235012	26
970235013	26
970235014	23
970235015	23
970235016	19
970235017	18
970236001	16
970236002	17
970236003	16
970236004	17
970236005	19
970236006	16

970236007	16
970236008	19
S8000-300	23
S8000-301	23
S8000-302	23
S804-470	23
S804-471	23
S804-472	23
S804-726	24
S804-727	24
S805-307	24
S805-308	24

A COMPANY OF THE
ROEMHELD GROUP

STARK

Spannsysteme

The ROEMHELD Group is represented in Germany and Austria with different products and orientations. With numerous subsidiaries, sales partners and service companies on all continents and in more than 50 countries, rapid and intensive customer support is provided in the mechanical engineering, medical technology, automotive, aviation and agricultural industries.

As part of the ROEMHELD Group, STARK benefits from the security and experience of a family-run traditional company as well as from the worldwide sales and service network. At the same time, this background provides the independence to pursue dynamic and innovative goals for new market-driven developments and customer-specific solutions with which STARK maintains its leading technological position.



ROEMHELD
HILMA ■ STARK

STARK Spannsysteme

A company of the ROEMHELD Group

STARK Spannsysteme GmbH
Römergrund 14 | 6830 Rankweil
Austria

+43 5522 37 400 - 0
info@stark-roemheld.com

stark-roemheld.com